



MakeUp Aria - MA.ABS.4C.0.1\_A01  
rev. 0.9\_24/04/2019

### General description

Bluetooth controllable, keypad for operation control with feedback led. The buttons can control a scene or an animation of the user's choice or simply one luminaire, one luminaire group or all lamps together if so desired if used with PLH Aria dimmers or any lighting fixture powered by Casambi or a PLH Aria Jellyfish output interface.

To be configured with Casambi app available for iOS (iPhone 4S or later, iPad 3 or later, iPod Touch 5th gen or later) and Android devices (Android 4.4 KitKat or later devices produced after 2013 with full Bluetooth 4.0 support).

### Technical specifications

Programmable push buttons	4
Type of inputs	Tact switch
Operating life	500.000 cycles
Feedback	Led blue on board
Battery type	3V CR2032 lithium coin cell
Lyfetime	10.000 click
Maximum output radio transceiver power:	2,4...2,483 Ghz +4 dBm
Range (depending on the surroundings)	up to 10 m
Contains FCC ID:	2ALA3-CBM002A
Contains IC	22496-CBM002A
Dimensions:	90 x 90 x 10 mm (3,54 x 3,54 x 0,39 inches)
Case	Polycarbonate body and buttons in aluminium
Weight:	100 g
Degree of protection:	IP20 (indoor use only)
Ambient temperature, ta:	- 20 ... + 45 °C
Max. case temperature, tc:	+ 65 °C
Max. relative humidity:	0...80%, non-cond.
Mark and regulations	CE

### Casambi Profile

3663 4 push buttons

**How to use it**

Check the instructions below for the configuration.

PLH MakeUp Aria is provided with 4 programmable buttons:

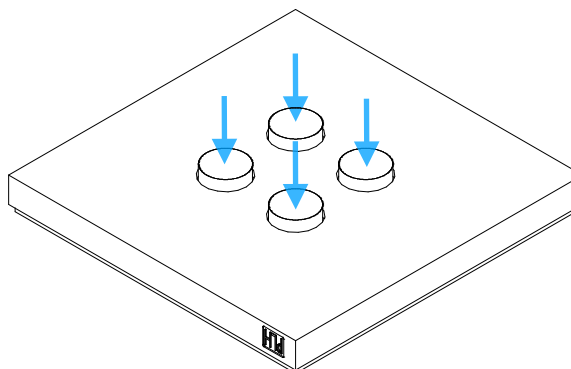
**How to change the battery**

Pull out gently the front plate from the wall. Release the old battery sliding it, and change with the new one CR2032. Respect the + symbol on the top.

Click the push button and check the functionality and the blue led on. Reinsert the front plate.

The PLH MakeUp Aria is supplied with the 3663 firmware preinstalled

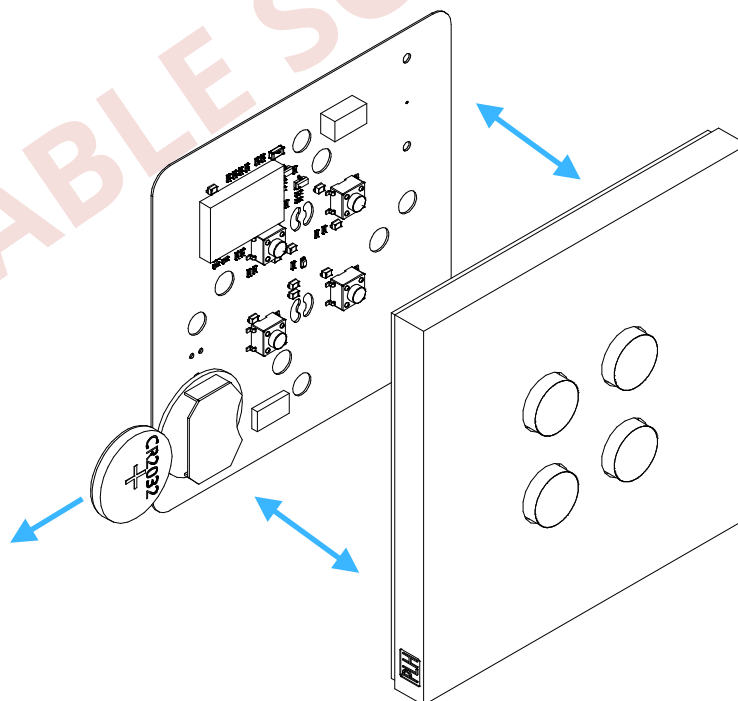

**Warranty**

We reserve the right to make technical and formal changes to the product in the interest of technical progress. Our products are under guarantee within the scope of the statutory provisions.

If you have a warranty claim, please contact PLH by e@mail ([support@plhitalia.com](mailto:support@plhitalia.com)) or the Local Reseller.



This product should not be disposed of with household waste.

Please recycle the products where facilities

for electronic waste exist. Check with your local authorities for recycling advice.

AVAILABLE SOON

### 1. Download the app

Download the free Casambi App directly from the AppStore or the Google Play



For all the functionality of the Casambi App download the Short User Guide from the Casambi website  
<https://casambi.com/static/datasheets/Short-user-guide.pdf>

### 2. Open the App

Before you open the app be carefull about this points:

- the Bluetooth need to be **ON** on your smartphone or tablet
- have done all the updates of the operating system;
- have installed and configured a Casambi device or a PLH Dimmer or PLH Jellyfish
- have created a 'Network'

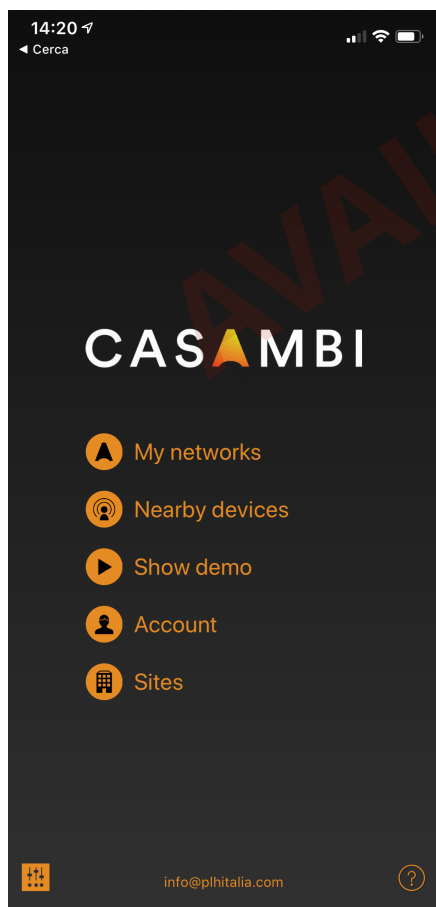

### 3. Add the device

To add the MakeUp Aria on your network you need to have installed a Casambi enabled lighting fixture, a PLH Dimmer or a PLH Jellyfish.  
 Refer to the specific manual for the installation of those devices.

After you open the Casambi App on your Smartphone, **take pressed** the main button of the MakeUp Aria and a window 'Found a new device' will appear.

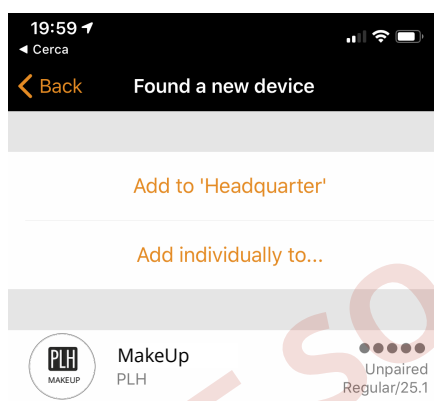

Then click on **Add individually to...**, change the Name of your MakeUp Aria, and add to your new network.

**Release the button only at the end of the process.**

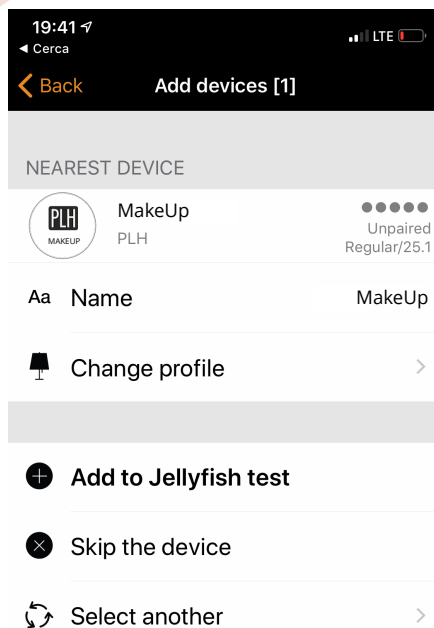

Take in mind that by default the profile is provided with the MakeUp 4P profile.

### 4. Assign input functionality

To assign and change the preferences of the MakeUp Aria go on **More / Switches** and select your MakeUp Aria

From the beginning all the input will be 'Not in use'.

**Tap to select** to change the functionality.

You can control any Casambi devices or scenarios.

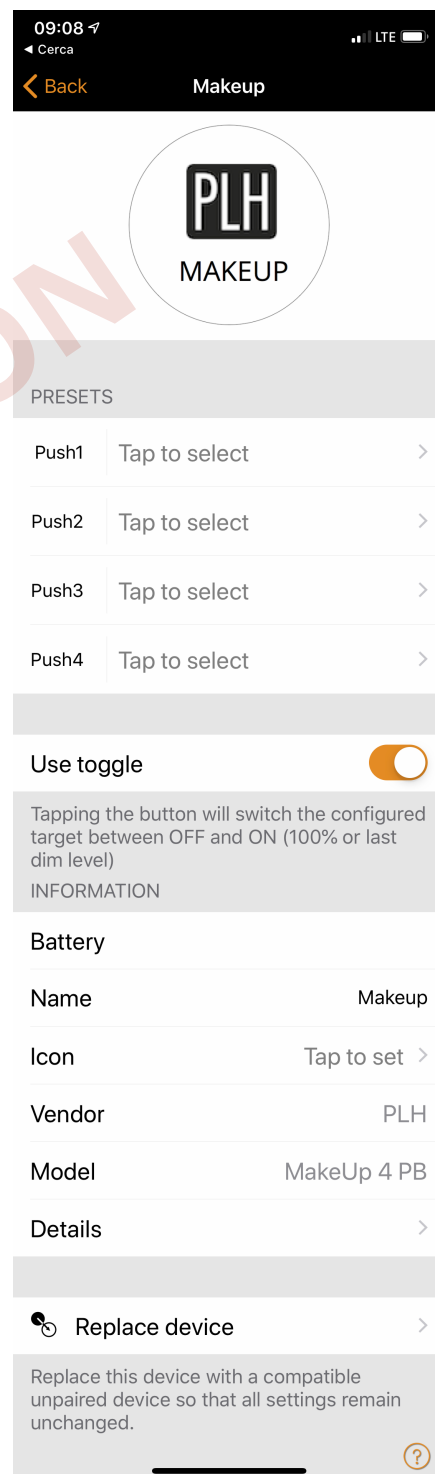

To control the Jellyfish output click on 'Control an element' and select then the right output

To control a PLH Dimmer click on 'Control a Luminaire'.

Refer to the Casambi App Manual for any further study.

## 5. Update the firmware

Time to time the firmware update window will appear for some maintenance stuff.

Then perform the update clicking on **Start update**.

**Don't forget to take pressed the main push button till the update is not ended.**

## 7. Troubleshooting

- 1) The MakeUp Aria is a battery device. If not function check the blue light turn on when you click the main push button. If not, change the battery following the instructions.
- 2) The MakeUp Aria use the bluetooth signal, for communicate between the devices. Refer to the Casambi website to discuss all aspects related to this technology.
- 3) You can control devices in a range up to 10m but it strongly depends by the surroundings. If the 'receiver' device like a Casambi Dimmer, is inside of a metal box this range can reduce significatively.

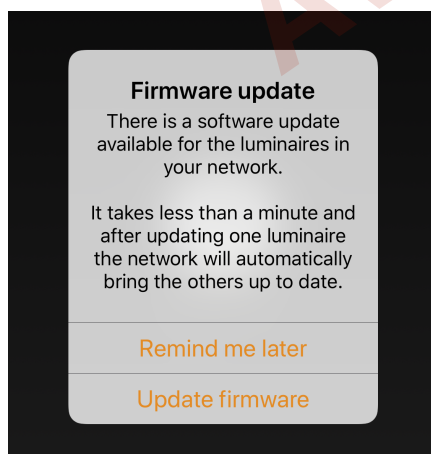



[www.plhitalia.com](http://www.plhitalia.com)



[info@plhitalia.com](mailto:info@plhitalia.com)



plhitalia  
#plhitalia



@plhitalia



PLH Italia

AVAILABLE SOON



Devices with soul.